

Cor. & Dist. up  
Buffaloe Creek

N. 49	W. 25.
S. 76	W. 100.
S. 6	W. 20.
N. 71	W. 83.
N. 16	E. 65.
N. 32	W. 66
359.	

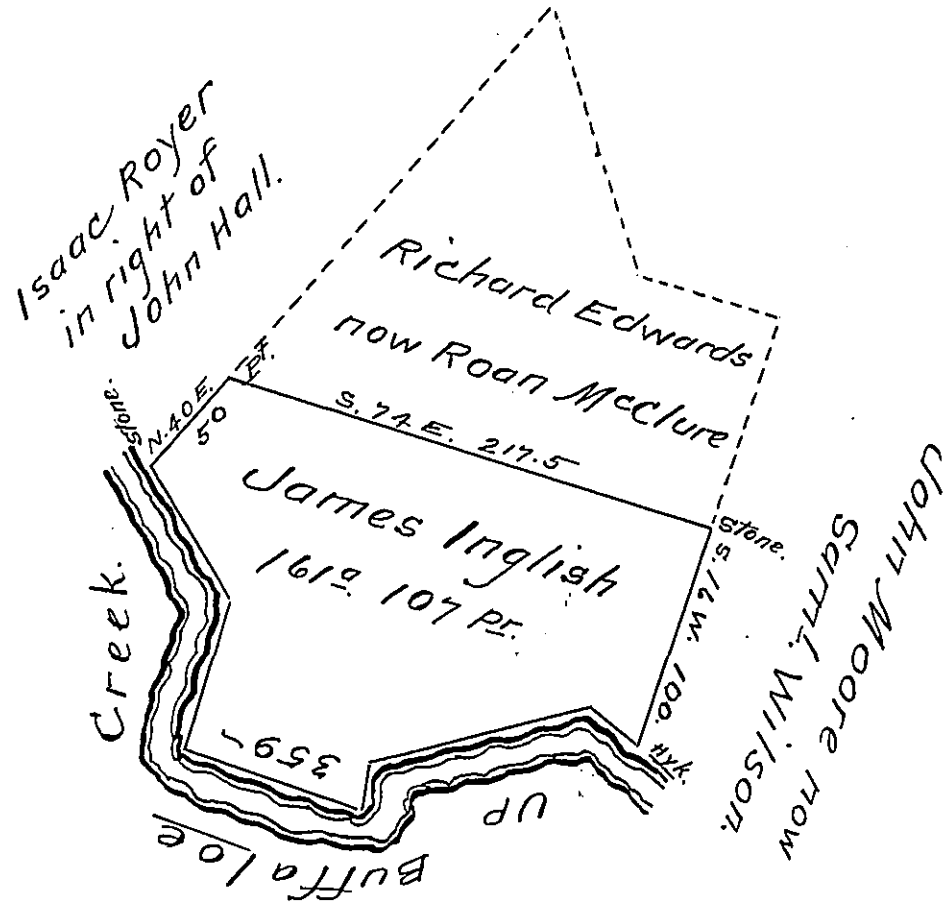

Situate in Kelly township Union (late Berks) County  
Surveyed the 6<sup>th</sup> day of May 1832 by virtue of an order  
Granted to James Inghish No 2988 dated the 8<sup>th</sup> of  
April 1769 Containing One hundred and sixty one Acres  
& 107 P<sup>s</sup> with the usual allowance of six P<sup>r</sup> Cent &c

The above described tract of land was surveyed  
the 12<sup>th</sup> day of August 1769 for Richard Edwards in  
pursuance of his order No 714 dated the 3<sup>d</sup> day of  
April 1769 - Now owned and possessed by Roan Mc  
Clure in right of Richard Edwards.

To Jacob Spangler Esq. }  
Surveyor General Pa. }

Pr Jm<sup>o</sup> Hayes, Con.

IN TESTIMONY that the above is a copy of the original remaining on file in  
the Department of Internal Affairs of Pennsylvania, made  
conformably to an Act of Assembly approved the 16th day of  
February, 1833, I have hereunto set my Hand and caused  
the Seal of said Department to be affixed at Harrisburg,  
this Twenty sixth day of August 1908.

Henry Howell  
Secretary of Internal Affairs.